



City of Westminster

Licensing Sub-Committee Report

Item No:	
Date:	8 February 2024
Licensing Ref No:	23/08418/LIPN - New Premises Licence
Title of Report:	61 Kingly Street London W1B 5QL
Report of:	Director of Public Protection and Licensing
Wards involved:	West End
Policy context:	City of Westminster Statement of Licensing Policy
Financial summary:	None
Report Author:	Jessica Donovan Senior Licensing Officer
Contact details	Telephone: 020 7641 6500 Email: Jdonovan@westminster.gov.uk

1. Application

1-A Applicant and premises			
Application Type:	New Premises Licence, Licensing Act 2003		
Application received date:	20 November 2023		
Applicant:	Mr Samirkumar Natvarbhai Patel		
Premises:	N/A		
Premises address:	61 Kingly Street London W1B 5QL	Ward:	West End
		Cumulative Impact Area:	West End
		Special Consideration Zone:	None
Premises description:	The premises intends to operate as a convenience store.		
Premises licence history:	<p>The premises has had the benefit of a premises licence since 2018 however, the licence was surrendered in February 2023 (22/02704/LIPDPS).</p> <p>A copy of the surrendered premises licence can be viewed at Appendix 3 of this report.</p> <p>A full licence history for the premises appears at Appendix 4.</p>		
Applicant submissions:	<p>The applicant has provided a response to the Licensing Authority's representation.</p> <p>A copy of the submissions can be found at Appendix 2.</p>		
Applicant amendments:	None		

1-B Proposed licensable activities and hours							
Sale by retail of alcohol				On or off sales or both:			Off sales
Day:	Mon	Tues	Wed	Thur	Fri	Sat	Sun
Start:	13:00	13:00	13:00	13:00	13:00	13:00	13:00
End:	23:00	23:00	23:00	23:00	23:00	23:00	23:00
Seasonal variations/ Non-standard timings:			N/A				

Hours premises are open to the public							
Day:	Mon	Tues	Wed	Thur	Fri	Sat	Sun
Start:	06:30	06:30	06:30	06:30	06:30	07:00	09:30
End:	23:00	23:00	23:00	23:00	23:00	23:00	23:00
Seasonal variations/ Non-standard timings:			N/A				

that the application will not add to cumulative impact if granted, it will be for Licensing Sub-Committee Members to determine this application, given its location within the West End Cumulative Impact zone.

Please accept this as a formal representation and we look forward to receiving any further submissions which will be forwarded on for Members information.

Responsible Authority:	Environmental Health Service
-------------------------------	------------------------------

Representative:	Anil Drayan
------------------------	-------------

Received:	18 December 2023
------------------	------------------

The premises are located in the West End Cumulative Impact Zone.

Environmental Health make representations against this application as the proposal may adversely impact on the Public Nuisance and Protection of Children from Harm licensing objectives.

In adequate conditions have been provided, such as, how alcohol shall be controlled from access to the public when the premises is open for non-licensable activities. I also understand the applicant is the same as the previous licence holder whom the Police had concerns how that licence was being operated.

The applicant is requested to contact the undersigned to discuss the above after which additional conditions may be proposed.

Responsible Authority:	Metropolitan Police Service
-------------------------------	-----------------------------

Representative:	PC Tom Stewart
------------------------	----------------

Received:	14 December 2023
------------------	------------------

I am writing on behalf of the Commissioner of the Metropolitan Police Service ("The Police") to make representations opposing the grant of a premises licence application for **61 Kingly Street London W1B 5QL.**

The application seeks the following:

Sale of Alcohol (off the premises)

Monday to Sunday 13:00 to 23:00

Opening Hours to Public

Monday to Sunday 06:30 to 23:00

The Police submit that, if granted, the premises would undermine the licensing objective 'The Prevention of Crime and Disorder, The prevention of Public Nuisance and The Protection of Children from Harm', as well as adversely affect cumulative impact within the West End Cumulative Impact Zone ("CIZ").

This premises falls within the Shops Policy ("SHP1") and it is the Licensing Authority's policy to consider such applications within the West End Cumulative Impact Zone on its merits and subject to the following:

- The applicant having demonstrated that they will not add to cumulative impact within the Cumulative Impact Zone
- The application meeting the requirements of policies CD1, PS1, PN1 and CH1.

The Police submit that the applicant has failed to address the above points. The Police submit that the application will adversely impact on Cumulative Impact. The applicant has failed to show how they will promote the licensing objectives, The Prevention of Crime and Disorder, the prevention of Public Nuisance and the Protection of Children from Harm (“CD1, PS1, PN1 and CH1”) by failing to provide sufficient conditions within the operating schedule.

The applicant has a history of non-compliance at the premises. The premises had the benefit of a premises licence (22/02704/LIPDPS) between March 2022 and March 2023. The licence was surrendered by the applicant following several breaches of the licence witnessed by Police. It is unclear what, if anything has changed at this time to demonstrate that the applicant will be able to comply with this premises licence or promote the licensing objectives if granted.

The Police request that this application is refused.

2-B Other Persons			
Name:		[REDACTED]	
Address and/or Residents Association:		[REDACTED]	
Status:	Valid	In support or objection:	OBJECTION
Received:	18 Dec 2023		
<p>We object to this application for a new licensed convenience store. 61 Kingly Street is in an area that is predominantly already made up of premises selling on and off sales of alcohol.</p> <p>There are too many shops selling alcohol in Soho. If people wanted to take alcohol home, they would buy it locally (no-one is far from a licensed convenience store in London). So the only purpose of buying from a convenience store is to drink it on the street. We know it is common practice in Soho for individuals or groups to purchase alcohol at convenience stores, wander round Soho, or gather in a public place, drink on the street, become inebriated, or more inebriated, and cause noise and bad behaviour including street urination. Inebriated people also attract crime gangs to the area and can be the victims of crime.</p> <p>We note that the application is for an extension of core hours to 23.00 on Sundays.</p> <p>The new CIA is pointing towards a presumption to refuse all new application applications and variations in the WECIZ.</p> <p>The Committee will be aware the premises is situated within the West End Cumulative Impact Zone and the onus is on the applicant to demonstrate they will not increase cumulative impact and will promote the licensing objectives.</p> <p>Increasing the number of licensed premises in the West End CIZ is highlighted in the recently published draft Cumulative Impact Assessment 2023, it confirms crime levels in Westminster has reached pre-COVID levels and since the last Cumulative Impact</p>			

Assessment 2020 crimes have concentrated even further in the West End. The modelling shows a 50% increase in undesirable behaviours from any new OR extended licence.

The evidence is clear any addition in the number of hours, the number of people consuming alcohol, the number of licensed premises will fail to promote the licensing objectives and increase cumulative impact. It concludes with a proposed new Licensing Authority Statement which states;

*'It is the view of the Licensing Authority that **the number of relevant authorisations in respect of premises in parts of the West End is such that it is likely that it would be inconsistent with the authority's duty under section 4(1) Licensing Act 2003 to grant any further relevant authorisations or variations in respect of premises in that area.** In accordance with section 5A(6) of the Licensing Act 2003 the Licensing authority will consult on its intention to publish this cumulative impact assessment prior to its final approval and publication.'* (**our emphasis**) (Appendix 1 Cumulative Impact, Appendix 2 Crime and Disorder).

Soho is at the heart of the West End's food, beverage and entertainment district with its **491** licensed premises, the demand for licensed premises in the West End and Soho shows no tendency to reduce, from 2020 to November 2023, 51 new alcohol licences have been granted with a capacity of over 4,245.

There are very real concerns amongst residents about the ever increasing numbers of licensed premises. We know residents who live near the premises already suffer from noise and disturbance which is caused by dispersal from premises in this area, its had a huge impact on their health and well being.

Residents have been subjected to noise disturbance and anti-social behaviour that are beyond acceptable levels. They are disturbed by the late night activity as people walk by (often shouting, or arguing), noise from pedicabs, car doors slamming, horns hooting, people vomiting and urinating [REDACTED]. Residents are also often disturbed even if an establishment is not located directly on their street, as customers (often noisy and intoxicated) leave premises and either carry on their night out in Soho or make their way home.

We know many residents experience sleep disturbance, [REDACTED] conducted a survey which confirms that residents are disturbed by noise at night, and say that this is having a negative impact on their lives. 87 people responded of which 78 are Soho residents with ages spread fairly evenly from 22 to 80, 59% of whom have lived in Soho for more than ten years.

When asked about disturbed sleep, 24% of respondents say they have their sleep disturbed seven nights a week, 16% five or six nights a week, and 19% three or four nights a week.

Furthermore, 64% of respondents agreed that noise nuisance from increased commercial activity at night is the most serious problem impacting Soho residents' quality of life.

62% of respondents agreed that the council should not grant any extensions of hours for premises in Soho.

60% of respondents agreed that noise nuisance and sleep deprivation is "adversely impacting my health" and the health of the people they live with.

46% of respondents agreed that noise nuisance is so bad that they have considered moving away from Soho.

The full survey can be found in **Appendix 3**.

In summary, this application for an off sales licence will increase cumulative impact and fail to promote the licensing objectives.

Yours faithfully,

[REDACTED]
[REDACTED]
[REDACTED]

Appendix 1 : Cumulative Impact

Appendix 2 : Crime and Disorder

Appendix 3 : ██████████ Sleep Survey Results

Appendix 4 : The Application

Appendix 5 : ██████████

Appendix 1 : Cumulative Impact

This area has been identified by Westminster City Council as under stress because of the cumulative effect of the concentration of licensed premises has led to serious problems of disorder and/or public nuisance affecting residents, visitors and other businesses. The evidence presented in the draft Cumulative Impact Assessment 2023 continues to show high levels of cumulative impact in the West End Zone 1 in 2022, it states,

*‘West End Zone is the epicentre for issues associated with cumulative impact within the **borough.**’ (p.50)*

The proposed Licensing Authority Statement strengthens the previous 2020 CIA statement in acknowledging the increasing and detrimental impact of the large number of licensed premises in the West End, it concludes,

*‘It is the view of the Licensing Authority that **the number of relevant authorisations in respect of premises in parts of the West End is such that it is likely that it would be inconsistent with the authority’s duty under section 4(1) Licensing Act 2003 to grant any further relevant authorisations or variations in respect of premises in that area.** In accordance with section 5A(6) of the Licensing Act 2003 the Licensing authority will consult on its intention to publish this cumulative impact assessment prior to its final approval and publication.’ (p.80)(our emphasis)*

In any application for an alcohol licence in the Cumulative Impact Zone the applicant is required to demonstrate that the application will not increase the Cumulative Impact. In the draft Cumulative Impact Assessment 2023 the modelling shows an overall factor of up to 1.5, which means that for every additional licence granted the number of undesirable behaviours expected in the area in a year would increase by up to a multiple of 1.5. This means a **50% increase in undesirable behaviours from any one new or extended licence, similarly the figures suggest a 26% increase in reported theft for each additional licence issued - for whatever type of venue: club, restaurant or café.** In relation to noise, it concludes,

‘The number of licensed premises is a significant factor in the generation of noise complaints.’

The policies in relation to the cumulative impact zone are directed at the global and cumulative effects of licences on the area as a whole (D16. of the SoLP).

D23. ‘The proximity of residential accommodation is a general consideration with regard to the prevention of public nuisance. It goes on, *‘The nature of cumulative impact is that it is cumulative and affects not only the immediate vicinity of the premises, but the wider area; thus the number of people visiting the premises, the nature of licensable activities and the lateness of operations have an impact on an area as a whole, irrespective of whether or not there is residential accommodation in proximity to the premises.’ (our emphasis)*

It is important to note the policy relates to the global effects of alcohol licences in the whole impact zone and not just a part of it.

Appendix 2 : Crime and Disorder

The draft Cumulative Impact Assessment 2023 states by September 2022 crime in Westminster had reached pre-pandemic levels. It compared the proportion of crimes that occurred in 2022 against the period of the 2020 CIA (2017 - 2019) it indicates that **‘crimes within Westminster has concentrated even further within West End Zone 1.’**

It confirmed the majority of the hotspots for the four major crime types (overnight thefts, robbery, drug offences, violence against person) were closely concentrated in the West

End, stating,

'This provides further evidence to the greater prevalence of criminal offences within this area, and given the temporal nature of this analysis, also suggests that criminal activity within this area is getting worse.'

Overall the West End Zone 1 accounts for:

- Just under 66% of all crime in Westminster
- 47% of violent crimes - approximately 59% at night (most prior to and after midnight)
- 44% (968) of all overnight robberies
- Over 65% of sexual offences.
- 52% of all night time alcohol related ASB
- 74% drug offences, small clusters include Soho - Old Compton Street
- 57% of all ASB call details included reference to public house/nightclub, night-time transport route, station, hotel or restaurant establishment

It confirms the majority of crime takes place on Friday / Saturday and Saturday/Sunday between 6pm - 6am. Overnight crime is identified as being particularly prevalent in Old Compton Street, Greek Street and Frith Street.

The level of crime, disorder and anti-social behaviour continues to be a huge problem in Soho, the crime figures are high and rising. The police crime reports for April/May 2023 shows current levels of alcohol related assaults, sexual assaults and robberies within the West End area are now higher than at pre-COVID levels. The peak times for crime being between 10pm - 2am.

In Soho the majority of robberies take place at night, with people being targeted as they leave venues. Alongside the robberies and assaults drug dealing is a huge problem with groups of dealers congregating to sell drugs to people as they leave premises or as they pass by. There are more dealers in the area at night than during the day, this is directly linked to the large number of venues and people which creates the drugs market. Pickpockets also operate in the area, they are a part of a well organised criminal group who arrive in a van at night and disperse into Soho before returning to be driven away.

It is well known that intoxicated people become victims of crime, their vulnerability being exploited by gangs or individuals who are in Soho explicitly to target them.

Appendix 3 : ██████████ Sleep Survey Results - 31 October 2022

There are real concerns amongst residents about the ever increasing numbers of licensed premises and people on the streets at night causing disturbance, they have been subjected to noise disturbance and anti-social behaviour that is beyond acceptable levels. They are disturbed by the late night activity as people walk by either shouting, screaming or arguing, noise from pedicabs, car doors slamming, horns honking, and are subjected to anti-social behaviour with people vomiting and urinating in the street and in their doorways.

Residents are also disturbed even if an establishment is not located directly on their street, as patrons usually intoxicated leave premises and either carry on their night out in Soho or as they make their way home making a noise and disturbing residents along the way.

It is therefore unsurprising that a survey conducted by ██████████ confirms that residents are disturbed by noise at night and this is having a negative impact on their lives.

87 people responded of which 78 are Soho residents with ages spread fairly evenly from 22 to 80, 59% having lived in Soho for more than 10 years.

59% have lived in Soho more than 10 years 26% between 3 and 10 years

6% between 1 and 3 years and

9% have lived here less than a year 42% own their homes

20% are Soho Housing Association and the rest tenants with other landlords 10 respondents

████████████████████ I find it extremely exhausting not able to have rest at night, Screams and noise of drunk people every night, The Landlord WCC does not want to change the windows to a double glazing nor allow tenants to pay privately for windows to be upgraded. Noise at home, lack of sleep, and concentration in the day time. I ████████████████████ I recorded noise levels of 97db outside the pub at the corner of ████████████████████

More consideration needs to be given to residents from councillors, people visiting the area and local businesses in particular those who serve alcohol and have late night licences. Decisions such as granting planning and licence applications should not be made by people who do not live in the area and are therefore not impacted by the decision making.

Very difficult to get the local authority to understand and take complaints seriously. Officers often helpful but then the case goes to committee and they always seem to rule in favour of the commercial premises rather than residents.

There is supposed to be a presumption to refuse new licences but in practice the council still lets new things through until after Midnight, which is far too late and has made a nonsense of the policy.

There should be a quiet window of 11pm to 8am every day. 7am deliveries are far too early for a lot of people if they are noisy or use cages or refrigeration.

████████████████████ Regularly now (most nights) there are traffic jams in the street at 3am in the morning with cars picking up people leaving clubs. The cars frequently are using their horns. Last night they had their door open with music blaring. we have 2 motorbike stands close together. 1 in ████████████████████ and 1 in ████████████████████ There is always at least one bike revving up at either 3am or really early like 530am This noise has changed and increased over the past 3-4 years. I am woken up most nights at about 3am. And i have double glazing and ████████████████████.

Businesses take no responsibility for their customers drinking/eating and mainly shouting outside, including when they are queuing, and particularly when they are leaving. Post al fresco, there is a new attitude that anything goes on the streets and that includes contempt for the community who live here. The Council need to rethink this and put some major resource into enforcement.

████████████████████ It's never been this noisy!

Early hours waste collections (including bottle smashing) also includes the food & beverage businesses putting their waste in the street and bottle bins at anti-social hours ahead of collection times. Our local restaurants are not supposed to put bottles out between the hours of 23:00 and 07:00 but they frequently do. Frequently delivery trucks some with noisy refrigeration units are also delivering early hours.

Also deliveries & pedicabs. Unfortunately my lack of sleep due to noise has caused serious health issues and I now cannot work and suffer anxiety and depression. I'm woken up on average 5 times per night and have considered suicide. Why I'm being denied sleep between the hours of 11pm and 7am astonishes me. The freeholders Shaftesbury Carnaby show a total disrespect to the effects that noise has on the residents of Soho

Appendix 4 : Application

New Premises Licence - 23/08418/LIPN

Convenience store with off licence sales of alcohol

Sales of Alcohol - off sales : Monday to Sunday: 13:00 - 23:00

Opening Hours: Monday to Friday : 06:30 - 23:00. Saturday : 07:00 - 23:00. Sunday : 09:30 - 23:00

Appendix 5 : ████████████████████

████████████████████ is a charitable company limited by guarantee established in 1972. ████████████████████

[REDACTED] and was formed to make Soho a better place to live, work or visit by preserving and enhancing the area's existing diversity of character and uses, and by improving its facilities, amenities and environment.

3. Policy & Guidance

The following policies within the City Of Westminster Statement of Licensing Policy apply:

Policy HRS1 applies

- A. Applications within the core hours set out below in this policy will generally be granted for the relevant premises uses, subject to not being contrary to other policies in the Statement of Licensing Policy.
- B. Applications for hours outside the core hours set out in Clause C will be considered on their merits, subject to other relevant policies, and with particular regard to the following:
1. The demonstration of compliance in the requirements of policies CD1, PS1, PN1 and CH1 associated with the likelihood of the effect of the grant of a licence for later or earlier hours on crime and disorder, public safety, public nuisance and the protection of children from harm.
 2. If the application is located within a Special Consideration Zone they have demonstrated that they have taken account of the issues identified in that area and provided adequate mitigation.
 3. Whether there is residential accommodation in the proximity of the premises that would likely be adversely affected by premises being open or carrying out operations at the hours proposed.
 4. The proposed hours of the licensable activities and when customers will be permitted to remain on the premises.
 5. The proposed hours when any music, including incidental music, will be played.
 6. The hours when customers will be allowed to take food or drink outside the premises or be within open areas which form part of the premises.
 7. The existing hours of licensable activities and the past operation of the premises (if any) and hours of licensable premises in the vicinity.
 8. Whether customers and staff have adequate access to public transport when arriving at and leaving the premises, especially at night.
 9. The capacity of the premises.
 10. The type of use, recognising that some venues are more likely to impact the licensing objectives than others; for example, pubs and bars are higher risk than theatres, cinemas and other cultural and sporting venues due to the nature of the operation.
 11. The Licensing Authority will take into account the active measures proposed for a 'winding down' period including arrangements for people to be collected from the premises to travel home safely.
 12. Conditions on hours may be attached that require that the supply of alcohol for consumption on the premises ceases a suitable period of time before customers are required to leave the premises.
 13. The council, acting as the Licensing Authority, may reduce hours if, after review, it is necessary to impose conditions specifying shorter hours in order to promote the licensing objectives.
 14. Specific days for non-standard hours should be identified and justified as part of the application to allow responsible authorities and interested parties to evaluate the impact that these licensable activities may have, and to plan accordingly. The consideration of applications for later hours for Bank Holiday Mondays will take into account that later hours are generally granted for preceding Sundays and that the next day is a working day. Non-specific days

	<p>are expected to be covered by Temporary Event Notices or variation applications.</p> <p>C. For the purpose of Clauses A and B above, the Core Hours for applications for each premises use type as defined within this policy are:</p> <ol style="list-style-type: none"> 1. Casinos: Up to 24 hours a day whilst casino gaming is permitted by a premises licence under the Gambling Act 2005. 2. Cinemas, Cultural Venues and Live Sporting Premises: Monday to Sunday: 9am to 12am 3. Hotels: Monday to Thursday: 9am to 11.30pm. Friday and Saturday: 9am to 12am. Sunday: 9am to 10.30pm. Sundays immediately prior to a bank holiday: 9am to 12am. For the sale of alcohol to guests for consumption in hotel/guest rooms only: Anytime up to 24 hours. 4. Off licences: Monday to Saturday: 8am to 11pm. Sunday: 9am to 10.30pm. 5. Outdoor Spaces: Monday to Thursday: 9am to 11.30pm. Friday and Saturday: 9am to 12am. Sunday: 9am to 10.30pm. Sundays immediately prior to a bank holiday: 9am to 12am. 6. Pubs and bars, Fast Food and Music and Dance venues: Monday to Thursday: 10am to 11.30pm. Friday and Saturday: 10am to 12am. Sunday: 9am to 10.30pm. Sundays immediately prior to a bank holiday: 12pm to 12am. 7. Qualifying Clubs: Monday to Thursday: 9am to 12am.. Friday and Saturday: 9am to 12am. Sunday: 9am to 10.30pm. Sundays immediately prior to a bank holiday: 9am to 12am. 8. Restaurants: Monday to Thursday: 9am to 11.30pm. Friday and Saturday: 9am to 12am. Sunday: 9am to 10.30pm. Sundays immediately prior to a bank holiday: 9am to 12am. 9. Sexual Entertainment Venues and Sex Cinemas: Monday to Thursday: 9am to 11.30pm. Friday and Saturday: 9am to 12am. Sunday: 9am to 10.30pm. Sundays immediately prior to a bank holiday: 9am to 12am. <p>D. Core hours are when customers are permitted to be on the premises and therefore the maximum opening hours permitted will be to the same start and terminal hours for each of the days where licensable activity is permitted.</p> <p>E. For the purposes of this policy, 'premises uses' are defined within the relevant premises use policies within this statement.</p>
<p>Policy SHP1 applies</p>	<p>A. Applications for a shop outside the West End Cumulative Impact Zone will generally be granted subject to:</p> <ol style="list-style-type: none"> 1. The application meeting the requirements of policies CD1, PS1, PN1 and CH1. 2. The hours for licensable activities are within the council's Core Hours Policy HRS1. 3. The operation of any delivery services for alcohol meeting the council's Ancillary Alcohol and/or Latenight Refreshment Delivery Service Policy DEL1. 4. The applicant having taken account of the Special Consideration Zone Policy SCZ1 if the premises are located within a designated zone. 5. The application and operation of the venue meeting the definition of a shop in Clause C. <p>B. Applications for a shop inside the West End Cumulative Impact Zone will be considered on their own merits and subject to:</p>

	<ol style="list-style-type: none"> 1. The application meeting the requirements of policies CD1, PS1, PN1 and CH1. 2. The hours for licensable activities are within the council's Core Hours Policy HRS1. 3. The operation of any delivery services for alcohol meeting the council's Ancillary Alcohol and/or Latenight Refreshment Delivery Service Policy DEL1. 4. The applicant having demonstrated that they will not add to cumulative impact within the Cumulative Impact Zone. 5. The application and operation of the venue meeting the definition of a shop in Clause C. <p>C. For the purposes of this policy:</p> <ol style="list-style-type: none"> 1. A shop is defined as a stall, vehicle, vessel, temporary structure, building or part of a stall, vehicle, vessel, temporary structure or building where the primary activity is the sale of goods or services to customers upon payment. 2. The licensable activities for the sale of alcohol for consumption on the premises, regulated entertainment and/or late night refreshment must be ancillary to the primary use of the premises as a shop. 3. The licensable activity of the sale of alcohol for consumption off the premises must be an ancillary function to the primary use of the premises unless that primary use is to sell alcohol for consumption off the premises, e.g. a traditional off licence.
--	---

4. Equality Implications

The Council in its capacity as Licensing Authority has a duty to have regard to its public sector equality duty under section 149 of the Equality Act 2010. In summary, section 149 provides that a Public Authority must, in the exercise of its functions, have due regard to the need to:

- (a) eliminate discrimination harassment, victimisation and any other conduct that is prohibited by or under this Act;
- (b) advance equality of opportunity between persons who share a relevant protected characteristic and persons who do not share it; and
- (c) foster good relations between persons who share a relevant protected characteristics and persons who do not share it.

Section 149 (7) of the Equality Act 2010 defines the relevant protected characteristics as age, disability, gender reassignment, marriage and civil partnership, pregnancy and maternity, race, religion or belief, sex, and sexual orientation.

5. Appendices

Appendix 1	Premises plans
Appendix 2	Applicant supporting documents
Appendix 3	Surrendered premises licence 22/02704/LIPDPS
Appendix 4	Premises history
Appendix 5	Proposed conditions
Appendix 6	Residential map and list of premises in the vicinity

Report author:	Jessica Donovan Senior Licensing Officer
Contact:	Telephone: 020 7641 6500 Email: Jdonovan@westminster.gov.uk

If you have any queries about this report or wish to inspect one of the background papers please contact the report author.

Background Documents – Local Government (Access to Information) Act 1972

1	Licensing Act 2003	N/A
2	City of Westminster Statement of Licensing Policy	01 October 2021
3	Amended Guidance issued under section 182 of the Licensing Act 2003	December 2022
4	Cumulative Impact Assessment	04 December 2023
5	The Licensing Authority representation	18 December 2023
6	Environmental Health Service representation	18 December 2023
7	Metropolitan Police representation	14 December 2023
8	Interested party representation	18 December 2023

PREMISES; KINGLY NEWS
61 KINGLY STREET
LONDON
W1B 5QL

 FIRE EXTINGUISHERS
1 X 4KG POWDER OR
EQUIVALENT

 LICENSABLE AREA

WHOLE OF LICENSABLE AREA
TO BE LICENSED FOR ALCOHOL
DISPLAY

MAXIMUM 15% OF RETAIL
SPACE FOR ALCOHOL DISPLAY

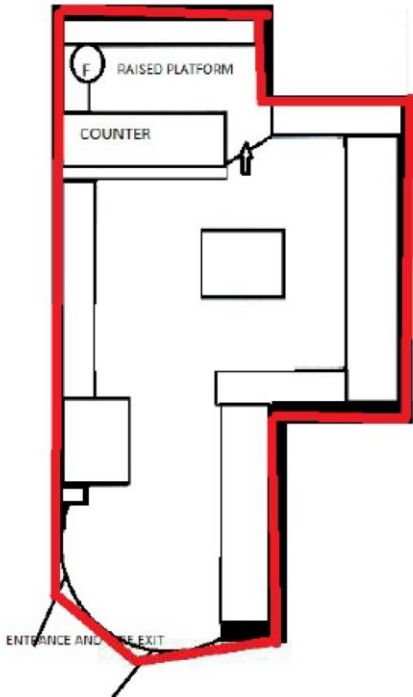

Applicant's response to the Licensing Authority representation

Dear Ms Haq,

I am aware of Mr Patel's past misdemeanours. I have discussed these with him and the possible consequences if he repeats them. He is cognescent of the applied meanings of all four licensing objectives and how they apply to his situation.

I suggested that he labels all containers of beers and ciders with the name and address of the shop to identify if his premises are responsible for that sale. Notices can be placed in the windows asking customers not to disturb the neighbours.

Please suggest conditions that might be acceptable to the authority that will allow you to grant the licence.

Regards,

████████

ADM Training Services

████████████████████

████████████████

██



City of Westminster
64 Victoria Street, London,
SW1E 6QP

Schedule 12
Part A

WARD: West End
UPRN: 100023470427

Premises licence

Regulation 33, 34

Premises licence
number:

22/02704/LIPDPS

Original Reference:

18/09828/LIPN

Part 1 – Premises details

Postal address of premises:

61 Kingly Street
London
W1B 5QL

Telephone Number: Not Supplied

Where the licence is time limited, the dates:

Not applicable

Licensable activities authorised by the licence:

Sale by Retail of Alcohol

The times the licence authorises the carrying out of licensable activities:

Sale by Retail of Alcohol

Monday to Sunday: 13:00 to 23:00

The opening hours of the premises:

Monday to Friday: 06:30 to 23:00
Saturday: 07:00 to 23:00
Sunday: 09:30 to 23:00

Where the licence authorises supplies of alcohol, whether these are on and/or off supplies:

Alcohol is supplied for consumption off the Premises.

Part 2

Name, (registered) address, telephone number and email (where relevant) of holder of premises licence:

██████████
██████████
██████
██████████

Registered number of holder, for example company number, charity number (where applicable)

N/A

Name, address and telephone number of designated premises supervisor where the premises licence authorises the supply of alcohol:

Name: Samirkumar Natvarbhai Patel

Please note: It is the policy of the Licensing Authority not to display the address details of a designated premises supervisor.

Personal licence number and issuing authority of personal licence held by designated premises supervisor where the premises licence authorises for the supply of alcohol:

Licence Number: 21/03470/LIPERS
Licensing Authority: London Borough of Croydon

Date: 6th April 2022

This licence has been authorised by Abigail Mugisa on behalf of the Director - Public Protection and Licensing.

Annex 1 – Mandatory conditions

1. No supply of alcohol may be made at a time when there is no designated premises supervisor in respect of this licence.
2. No supply of alcohol may be made at a time when the designated premises supervisor does not hold a personal licence or the personal licence is suspended.
3. Every supply of alcohol under this licence must be made or authorised by a person who holds a personal licence.
4.
 - (1) The premises licence holder or club premises certificate holder must ensure that an age verification policy is adopted in respect of the premises in relation to the sale or supply of alcohol.
 - (2) The designated premises supervisor in relation to the premises licence must ensure that the supply of alcohol at the premises is carried on in accordance with the age verification policy.
 - (3) The policy must require individuals who appear to the responsible person to be under 18 years of age (or such older age as may be specified in the policy) to produce on request, before being served alcohol, identification bearing their photograph, date of birth and either –
 - (a) a holographic mark, or
 - (b) an ultraviolet feature.
5.
 - (i) A relevant person shall ensure that no alcohol is sold or supplied for consumption on or off the premises for a price which is less than the permitted price.
 - (ii) For the purposes of the condition set out in paragraph 5(i) above -
 - (a) "duty" is to be construed in accordance with the Alcoholic Liquor Duties Act 1979;
 - (b) "permitted price" is the price found by applying the formula -
$$P = D+(D \times V)$$
Where -
 - (i) P is the permitted price,
 - (ii) D is the amount of duty chargeable in relation to the alcohol as if the duty were charged on the date of the sale or supply of the alcohol, and
 - (iii) V is the rate of value added tax chargeable in relation to the alcohol as if the value added tax were charged on the date of the sale or supply of the alcohol;
 - (c) "relevant person" means, in relation to premises in respect of which there is in force a premises licence –
 - (i) the holder of the premises licence,

- (ii) the designated premises supervisor (if any) in respect of such a licence, or
 - (iii) the personal licence holder who makes or authorises a supply of alcohol under such a licence;
- (d) "relevant person" means, in relation to premises in respect of which there is in force a club premises certificate, any member or officer of the club present on the premises in a capacity which enables the member or officer to prevent the supply in question; and
- (e) "value added tax" means value added tax charged in accordance with the Value Added Tax Act 1994.

5

- (iii). Where the permitted price given by Paragraph 5(ii)(b) above would (apart from this paragraph) not be a whole number of pennies, the price given by that sub-paragraph shall be taken to be the price actually given by that sub-paragraph rounded up to the nearest penny.
- 5(iv). (1) Sub-paragraph 5(iv)(2) below applies where the permitted price given by Paragraph 5(ii)(b) above on a day ("the first day") would be different from the permitted price on the next day ("the second day") as a result of a change to the rate of duty or value added tax.
- (2) The permitted price which would apply on the first day applies to sales or supplies of alcohol which take place before the expiry of the period of 14 days beginning on the second day.

Annex 2 – Conditions consistent with the operating Schedule

None

Annex 3 – Conditions attached after a hearing by the licensing authority

6. Staff training shall be recorded and updated every 6 months Training shall cover the requirements for ID as part of age verification, how to detect proxy sales, the consequences of underage sales (fines and punishment) , drunks , and other relevant matters as regards the licensing act, and the responsibilities of staff.
7. The licence holder shall ensure that a refusals register is kept on the premises and that this shall be immediately available upon request of an authorised officer. The register shall record any refused sale of alcohol.. The refusal register shall be inspected on a regular basis by the DPS and signed by the DPS that they have checked the register. At least 12 months of refusal register details shall be retained and made available upon request by an authorised officer
8. There shall be a documented reporting structure back to the Designated Premises Supervisor (DPS) and premises licence holder which shall include telephone contact numbers. This reporting document shall be immediately available upon request of an authorised officer
9. Notices shall be prominently displayed at all exits requesting patrons to respect the needs of local residents and businesses and leave the area quietly.
10. Signage shall be prominently displayed warning customers of the legal penalties for purchasing alcohol for any person under the age of 18 years.
11. The premises shall install and maintain a comprehensive CCTV system as per the following minimum requirements of the Westminster Police Licensing Team. All entry and exit points will be covered enabling frontal identification of every person entering in any light condition. The CCTV system shall continually record whilst the premises is open for licensable activities and during all times when customers remain on the premises. All recordings shall be stored for a minimum period of 31 days with date and time stamping. Viewing of recordings shall be made available immediately upon the request of Police or authorised officer throughout the entire 31-day period in line with data protection law (such as a section 29 request). The CCTV system shall be checked regularly to ensure it is working in line with the requirements of the licence.
12. A staff member from the premises who is conversant with the operation of the CCTV system shall be on the premises at all times when the premises is open. This staff member must be able to provide a Police or authorised council officer copies of recent CCTV images or data with the absolute minimum of delay when requested.
13. A Challenge 25 proof of age scheme shall be operated at the premises where the only acceptable forms of identification are recognised photographic identification cards, such as a driving licence, passport or proof of age card with the PASS Hologram.
14. An incident log shall be kept at the premises, and made available on request to an authorised officer of the City Council or the Police. It must be completed within 24 hours of the incident and will record the following:
 - (a) all crimes reported to the venue
 - (b) all ejections of patrons
 - (c) any complaints received concerning crime and disorder
 - (d) any incidents of disorder
 - (e) any faults in the CCTV system
 - (f) any refusal of the sale of alcohol
 - (g) any visit by a relevant authority or emergency service.

15. All sales of alcohol for consumption off the premises shall be in sealed containers only, and shall not be consumed on the premises.
16. No super-strength beer, lagers, ciders or spirit mixtures of 5.5% ABV (alcohol by volume) or above shall be sold at the premises, except for premium beers and ciders supplied in glass bottles.
17. No more than 15% of the sales area shall be used at any one time for the sale, exposure for sale, or display of alcohol.
18. There shall be no self-service of spirits on the premises, save for spirit mixtures less than 5.5% ABV.
19. There shall be no deliveries of alcohol before 8am or after 8pm
20. There shall be litter patrols on a regular basis (at least daily).
21. There shall be no single can sales - minimum quantity in can sales to be four cans.
22. Outside of the hours authorised for the sale of alcohol and whilst the premises are open to the public, the licence holder shall ensure that all alcohol within the premises (including alcohol behind the counter) is secured in a locked store room or behind locked grilles, locked screens or locked cabinet doors so as to prevent access to the alcohol by both customers and staff.
23. Prominent signage indicating the permitted hours for the sale of alcohol shall be displayed so as to be visible before entering the premises, where alcohol is on public display, and at the point of sale.
24. All tills shall automatically prompt staff to ask for age verification identification when presented with an alcohol sale.
25. There shall be a personal licence holder on duty on the premises at all times when the premises are authorised to sell alcohol.

Annex 4 – Plans

PREMISES; KINGLY NEWS
61 KINGLY STREET
LONDON
W1B 5QL

 FIRE EXTINGUISHERS
1 X 4KG POWDER OR
EQUIVALENT

 LICENSABLE AREA

WHOLE OF LICENSABLE AREA
TO BE LICENSED FOR ALCOHOL
DISPLAY

MAXIMUM 15% OF RETAIL
SPACE FOR ALCOHOL DISPLAY

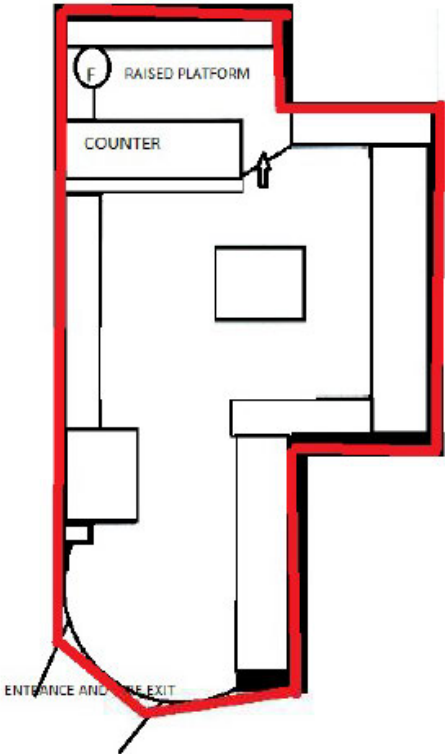



City of Westminster
64 Victoria Street, London,
SW1E 6QP

Schedule 12
Part B

Premises licence
summary

WARD: West End
UPRN: 100023470427

Regulation 33, 34

Premises licence
number:

22/02704/LIPDPS

Part 1 – Premises details

Postal address of premises:

61 Kingly Street
London
W1B 5QL

Telephone Number: Not Supplied

Where the licence is time limited, the dates:

Not applicable

Licensable activities authorised by the licence:

Sale by Retail of Alcohol

The times the licence authorises the carrying out of licensable activities:

Sale by Retail of Alcohol

Monday to Sunday: 13:00 to 23:00

The opening hours of the premises:

Monday to Friday: 06:30 to 23:00
Saturday: 07:00 to 23:00
Sunday: 09:30 to 23:00

Where the licence authorises supplies of alcohol, whether these are on and/or off
supplies:

Alcohol is supplied for consumption off the Premises.

Name and (registered) address of holder of premises licence:

██████████
██████████
██████
██████

Registered number of holder, for example company number, charity number (where applicable)

N/A

Name of designated premises supervisor where the premises licence authorises for the supply of alcohol:

Name: Samirkumar Natvarbhai Patel

State whether access to the premises by children is restricted or prohibited:

Restricted

Date: 6th April 2022

This licence has been authorised by Abigail Mugisa on behalf of the Director - Public Protection and Licensing.

Premises History**Appendix 4**

Application	Details of Application	Date Determined	Decision
07/04170/LIPN	New premises licence Sale by Retail of Alcohol Monday to Saturday 08:00 to 23:00 Sunday 10:00 to 22:30	02.08.2007	Refused by Licensing Sub-Committee
18/09828/LIPN	New premises licence Sale by Retail of Alcohol Monday to Sunday: 10:00 to 20:00	17.12.2018	Granted by Licensing Sub-Committee
21/04146/LIPVM	Minor Variation: To vary the hours for the sale of alcohol of the premises to 13:00 to 23:00 Monday to Sunday	21.05.2021	Granted under Delegated Authority
22/02703/LIPT	Transfer application: Regency Coffee Boutique Limited to Mr Samirkumar Natvarbhai Patel	30.03.2022	Granted under Delegated Authority
22/02704/LIPDPS	Application to Vary the Designated Premises Supervisor	01.04.2022	Granted under Delegated Authority <i>Surrendered February 2023</i>

There is no appeal or Temporary Event Notice history

CONDITIONS CONSISTENT WITH THE OPERATING SCHEDULE AND CONDITIONS PROPOSED BY A PARTY TO THE HEARING

When determining an application for a new premises licence under the provisions of the Licensing Act 2003, the licensing authority must, unless it decides to reject the application, grant the licence subject to the conditions which are indicated as mandatory in this schedule.

At a hearing the licensing authority may, in addition, and having regard to any representations received, grant the licence subject to such conditions which are consistent with the operating schedule submitted by the applicant as part of their application, or alter or omit these conditions, or add any new condition to such extent as the licensing authority considers necessary for the promotion of the licensing objectives.

This schedule lists those conditions which are consistent with the operating schedule, or proposed as necessary for the promotion of the licensing objectives by a responsible authority or an interested party as indicated. These conditions have not been submitted by the licensing service but reflect the positions of the applicant, responsible authority or interested party and have not necessarily been agreed

Mandatory Conditions

1. No supply of alcohol may be made at a time when there is no designated premises supervisor in respect of this licence.
2. No supply of alcohol may be made at a time when the designated premises supervisor does not hold a personal licence or the personal licence is suspended.
3. Every supply of alcohol under this licence must be made or authorised by a person who holds a personal licence.
4.
 - (1) The premises licence holder or club premises certificate holder must ensure that an age verification policy is adopted in respect of the premises in relation to the sale or supply of alcohol.
 - (2) The designated premises supervisor in relation to the premises licence must ensure that the supply of alcohol at the premises is carried on in accordance with the age verification policy.
 - (3) The policy must require individuals who appear to the responsible person to be under 18 years of age (or such older age as may be specified in the policy) to produce on request, before being served alcohol, identification bearing their photograph, date of birth and either—
 - (a) a holographic mark, or
 - (b) an ultraviolet feature.
- 5(i) A relevant person shall ensure that no alcohol is sold or supplied for consumption on or off the premises for a price which is less than the permitted price.
- 5(ii) For the purposes of the condition set out in paragraph 5(i) above -
 - (a) "duty" is to be construed in accordance with the Alcoholic Liquor Duties Act

1979;

(b) "permitted price" is the price found by applying the formula -

$$P = D + (D \times V)$$

Where -

- (i) P is the permitted price,
- (ii) D is the amount of duty chargeable in relation to the alcohol as if the duty were charged on the date of the sale or supply of the alcohol, and
- (iii) V is the rate of value added tax chargeable in relation to the alcohol as if the value added tax were charged on the date of the sale or supply of the alcohol;

(c) "relevant person" means, in relation to premises in respect of which there is in force a premises licence -

- (i) the holder of the premises licence,
- (ii) the designated premises supervisor (if any) in respect of such a licence, or
- (iii) the personal licence holder who makes or authorises a supply of alcohol under such a licence;

(d) "relevant person" means, in relation to premises in respect of which there is in force a club premises certificate, any member or officer of the club present on the premises in a capacity which enables the member or officer to prevent the supply in question; and

(e) "value added tax" means value added tax charged in accordance with the Value Added Tax Act 1994.

5(iii). Where the permitted price given by Paragraph 5(ii)(b) above would (apart from this paragraph) not be a whole number of pennies, the price given by that sub-paragraph shall be taken to be the price actually given by that sub-paragraph rounded up to the nearest penny.

5(iv). (1) Sub-paragraph 5(iv)(2) below applies where the permitted price given by Paragraph 5(ii)(b) above on a day ("the first day") would be different from the permitted price on the next day ("the second day") as a result of a change to the rate of duty or value added tax.

(2) The permitted price which would apply on the first day applies to sales or supplies of alcohol which take place before the expiry of the period of 14 days beginning on the second day.

Conditions consistent with the operating schedule

6. There shall be a personal licence holder on duty on the premises at all times when the premises are authorised to sell alcohol. No supply of alcohol will be made when there is no designated premises supervisor is not present at the shop nor will any supply of alcohol be made at a time the designated premises supervisor does not hold a personal licence or their licence is suspended.

7. The premises licence holder shall ensure that all training records shall be retained for 12 months and made available to police and local authority officers upon reasonable request.

8. No alcohol will be sold or supplied at the premises for a price which is less than the permitted price.
9. At all times when the premise is open, a person who can operate the CCTV system must be present on the premises.
10. CCTV camera system covering both internal and external to the premises is to be installed.
11. The CCTV recordings are to be maintained for 30 days and to be provided upon request to either a Police Officer or an officer of any other Responsible Authority.
12. An incident log shall be kept at the premises and shall be made available for inspection by Police or Council Officers upon reasonable request which should record the following;

All crimes reported to the venue
All ejections of patrons
Any complaints received
Any incidents of disorder
Any visit by a relevant authority or emergency service.
13. Notices shall be prominently displayed at all exits requesting patrons to respect the needs of local residents and leave the area quietly.
14. There shall be no self-service of spirits on the premises.
15. A Challenge 25 policy will be operated at the premises whereby anyone who appears to be under the age of 25 shall be asked to provide proof of age that he or she is over 18. Proof of age shall only comprise of a passport, a photo-card driving licence or an industry approved proof of age identity card. Notices shall be displayed in the premises to advise patrons and staff that a 'Challenge 25' operates in the premises. Any refusals of sale of age related products are recorded in a refusals logs as is reasonably practicable after the sale is refused. The log should show the date and time of the event, the products sought, the gender and approximate age of the customer and a description of the customer and the name of the member of staff who refused the sale. The refusal log shall be made available for inspection by the Police or Council Officers.

Conditions proposed by the Licensing Authority

None

Conditions proposed by the Environmental Health Service

None

Conditions proposed by the Metropolitan Police Service

None

61 Kingly Street, London, W1B 5QL



26/01/2024, 11:52:48

- Property Mailing List
- ▭ Ward Boundaries
- ▭ Ward Labels

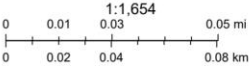

Resident Count: 7

Licensed premises within 75 metres of 61 Kingly Street, London, W1B 5QL

Licence Number	Trading Name	Address	Premises Type	Time Period
19/16795/LIPVM	Dehesa	17 Kingly Street London W1B 5PU	Restaurant	Monday; 10:00 - 00:00 Tuesday; 10:00 - 00:00 Wednesday; 10:00 - 00:00 Thursday; 10:00 - 00:00 Friday; 10:00 - 00:30 Saturday; 10:00 - 00:30 Sunday; 12:00 - 23:00 Monday to Thursday; 10:00 - 00:00 Friday to Saturday; 10:00 - 00:30
23/04230/LIPN	Hugo Boss - 178-180 Regent Street	180 Regent Street London W1B 5TW	Shop (large)	Monday; 10:00 - 21:00 Tuesday; 10:00 - 21:00 Wednesday; 10:00 - 21:00 Thursday; 10:00 - 21:00 Friday; 10:00 - 21:00 Saturday; 10:00 - 21:00 Sunday; 10:00 - 21:00
23/05192/LIPDPS	Blue Posts Public House	18 Kingly Street London W1B 5PX	Public house or pub restaurant	Sunday; 08:00 - 23:00 Monday to Thursday; 08:00 - 23:30 Friday to Saturday; 08:00 - 00:00 Sundays before Bank Holidays; 08:00 - 00:00
21/03716/LIPVM	Crispin	19 Kingly Street London W1B 5PY	Restaurant	Sunday; 10:00 - 22:30 Monday to Thursday; 08:00 - 23:30 Friday to

				Saturday; 08:00 - 00:00
23/05150/LIPT	Jinjuu	Basement And Ground Floor 15 - 16 Kingly Street London W1B 5PT	Restaurant	Monday; 10:00 - 01:30 Tuesday; 10:00 - 01:30 Wednesday; 10:00 - 01:30 Thursday; 10:00 - 01:30 Friday; 10:00 - 01:30 Saturday; 10:00 - 01:30 Sunday; 12:00 - 00:00
18/12995/LIPDPS	Hamleys	Basement To Seventh Floor 188 - 196 Regent Street London W1B 5QR	Shop (very large)	Saturday; 09:00 - 20:00 Sunday; 12:00 - 18:00 Monday to Wednesday; 10:00 - 20:00 Thursday to Friday; 10:00 - 21:00
14/03870/LIPT	Mother Mash	26 Ganton Street London W1F 7QZ	Public house or pub restaurant	Monday to Friday; 08:00 - 23:00 Saturday to Sunday; 10:00 - 23:00
20/07653/LIPDPS	Aint Nothin But	20 Kingly Street London W1B 5PZ	Wine bar	Sunday; 09:00 - 00:00 Monday to Thursday; 09:00 - 01:30 Friday to Saturday; 09:00 - 03:30 Sundays before Bank Holidays; 09:00 - 01:30
23/08251/LIPVM	Rosas	23A Ganton Street London W1F 9BW	Cafe	Sunday; 12:00 - 23:00 Monday to Thursday; 10:00 - 23:30 Friday to Saturday; 10:00 - 00:00 Christmas Eve; 12:00 - 00:00 Christmas Eve; 10:00 - 00:00 Sundays before Bank Holidays;

				12:00 - 00:00
21/03365/LIPDPS	Kolamba	21 Kingly Street London W1B 5QA	Restaurant	Sunday; 10:00 - 23:00 Monday to Thursday; 10:00 - 00:00 Friday to Saturday; 10:00 - 00:30 Sundays before Bank Holidays; 10:00 - 00:30
23/02692/LIPDPS	Pix	Basement And Ground Floor 24 Ganton Street London W1F 7QY	Restaurant	Sunday; 12:00 - 22:30 Monday to Thursday; 12:00 - 23:30 Friday to Saturday; 12:00 - 00:00
23/03147/LIPT	Wright Brothers Soho	12 - 13 Kingly Street London	Restaurant	Sunday; 08:00 - 23:00 Monday to Saturday; 08:00 - 00:00
23/08647/LIPDPS	Red Lion Public House	14 Kingly Street London W1B 5PR	Public house or pub restaurant	Sunday; 12:00 - 23:00 Monday to Thursday; 10:00 - 23:30 Friday to Saturday; 10:00 - 00:00
15/00525/LIPN	Pizza Pilgrims Kiosk	11 Kingly Street London W1B 5PL	Shop	Saturday; 10:00 - 23:00 Sunday; 10:00 - 22:30 Monday to Saturday; 08:00 - 23:00
23/09186/LIPVM	Pizza Pilgrims	11 Kingly Street London W1B 5PL	Shop	Monday; 08:00 - 00:30 Tuesday; 08:00 - 00:30 Wednesday; 08:00 - 00:30 Thursday; 08:00 - 00:30 Friday; 08:00 - 00:30 Saturday; 08:00 - 00:30 Sunday; 08:00 - 00:30
22/01668/LIPDPS	The Ganton Arms	18 - 20 Ganton Street	Restaurant	Sunday; 12:00 - 00:00 Monday to

		London W1F 7BX		Friday; 10:00 - 00:30
17/09470/LIPV	Pastaio	19 Ganton Street London W1F 9BN	Restaurant	Sunday; 12:00 - 23:00 Monday to Thursday; 10:00 - 00:00 Friday to Saturday; 10:00 - 00:30
22/12065/LIPVM	Cirque Le Soir	Basement 15-21 Ganton Street London W1F 9BN	Night clubs and discos	Monday; 00:00 - 00:00 Wednesday; 00:00 - 00:00 Thursday; 00:00 - 00:00 Friday; 00:00 - 00:00 Saturday; 00:00 - 00:00 Wednesday to Saturday; 00:00 - 00:00
18/07664/LIPDPS	Cirque Le Soir	Basement 15-21 Ganton Street London W1F 9BN	Night clubs and discos	Monday; 00:00 - 00:00 Wednesday to Saturday; 00:00 - 00:00
22/09921/LIPT	The Court	9 Kingly Street London W1B 5PH	Club or institution	Saturday; 09:00 - 00:30 Sunday; 12:00 - 23:00 Monday to Friday; 09:00 - 03:30
22/05147/LIPN	Shadow Licence	9 Kingly Street London W1B 5PH	Premises Licence - Shadow Licence	Saturday; 09:00 - 00:30 Sunday; 12:00 - 23:00 Monday to Friday; 09:00 - 03:30
23/05401/LIPN	Not Recorded	9 - 11 Kingly Street London W1B 5PH	Night clubs and discos	Sunday; 12:00 - 23:00 Monday to Saturday; 09:00 - 01:30
23/04741/LIPT	Patty & Bun	Ground Floor 26 Kingly Street London W1B 5QD	Restaurant	Monday to Sunday; 11:00 - 00:00
21/02690/LIPDPS	Flare	14 - 22 Ganton Street London W1F	Public house or pub restaurant	Sunday; 12:00 - 22:30 Sunday; 12:00 - 23:30

		7BS		Monday to Wednesday; 09:00 - 00:00 Monday to Thursday; 10:00 - 23:30 Thursday to Saturday; 09:00 - 01:00 Friday to Saturday; 10:00 - 00:00 Sundays before Bank Holidays; 12:00 - 00:00
23/04406/LIPDPS	El Pollote	13 Ganton Street London W1F 9BL	Cafe	Sunday; 12:00 - 22:30 Monday to Thursday; 10:00 - 23:30 Friday to Saturday; 10:00 - 00:00
24/00353/LIPCH	Rum Kitchen, First Floor, Units 1.12 And 1.13	First Floor 12 Kingly Court London W1B 5PW	Restaurant	Sunday; 12:00 - 23:00 Monday to Thursday; 10:00 - 00:00 Friday to Saturday; 10:00 - 00:30
22/09539/LIPDPS	Cahoots	Unit G 13 Kingly Court London W1B 5PW	Night clubs and discos	Sunday; 09:00 - 00:00 Monday to Wednesday; 09:00 - 03:00 Thursday to Saturday; 09:00 - 03:30
17/08811/LIPN	Smeg St James's	Regent Street London	Shop	Sunday; 12:00 - 18:00 Monday to Saturday; 10:00 - 19:00
19/11048/LIPDPS	Regent Street Area	Regent Street London	Park / Open Space	Monday to Sunday; 00:00 - 00:00
23/07892/LIPDPS	Marsha	Ground Floor Unit 2 And First Floor Units 4-6 Kingly Court Kingly Court London W1B 5PW	Restaurant	Sunday; 07:00 - 22:30 Monday to Thursday; 07:00 - 23:30 Friday to Saturday; 07:00 - 00:00
19/09764/LIPCH	Shoryu	Ground	Restaurant	Sunday; 12:00

		Floor Unit 3-5 Kingly Court Kingly Court London W1B 5PW		- 23:00 Monday to Thursday; 10:00 - 00:00 Friday to Saturday; 10:00 - 00:30
15/11467/LIPDPS	Le Bab (Units 2.10 And 2.11)	Kingly Court Kingly Street London W1B 5PW	Restaurant	Sunday; 12:00 - 23:00 Monday to Thursday; 10:00 - 00:00 Friday to Saturday; 10:00 - 00:30
23/07091/LIPVM	Oka Restaurant Units 1.14 - 1.16	Kingly Court Kingly Street London W1B 5PW	Restaurant	Sunday; 12:00 - 23:00 Monday to Thursday; 10:00 - 00:00 Friday to Saturday; 10:00 - 00:30
23/08566/LIPDPS	Imads Syrian Kitchen Ltd	Second Floor Unit 14 Kingly Court Kingly Court London W1B 5PW	Restaurant	Sunday; 12:00 - 23:00 Monday to Thursday; 10:00 - 00:00 Friday to Saturday; 10:00 - 00:30
23/01272/LIPVM	Imad's Syrian Restaurant	Second Floor Unit 14 Kingly Court Kingly Court London W1B 5PW	Restaurant	Sunday; 09:00 - 22:30 Monday to Thursday; 09:00 - 23:30 Friday to Saturday; 09:00 - 00:00
18/08932/LIPDPS	Senor Ceviche	First Floor Units 1-3 Kingly Court Kingly Court London W1B 5PW	Restaurant	Sunday; 12:00 - 23:00 Monday to Thursday; 10:00 - 00:00 Friday to Saturday; 10:00 - 00:30
23/02760/LIPT	Units 1.7 And 1.8, First Floor	Kingly Court Kingly Street London W1B 5PW	Restaurant	Sunday; 12:00 - 23:00 Monday to Thursday; 10:00 - 00:00 Friday to Saturday; 10:00 - 00:30
21/10252/LIPDPS	Korean Dinner Party	Kingly Court Kingly Street	Restaurant	Sunday; 12:00 - 23:00

		London W1B 5PW		Monday to Thursday; 10:00 - 00:00 Friday to Saturday; 10:00 - 00:30
23/05097/LIPDPS	Unit 2.1-2.4 Kingly Court	Second Floor Units 1 And 2 Kingly Court Kingly Street London W1B 5PW	Restaurant	Sunday; 09:00 - 22:30 Monday to Thursday; 09:00 - 23:30 Friday to Saturday; 09:00 - 00:00
21/03852/LIPT	Ralphps Coffee & Bar	Sceptre House 169 - 173 Regent Street London W1B 4JG	Wine bar	Sunday; 11:00 - 18:00 Monday to Saturday; 10:00 - 21:00